

Summary of Proposed Cultivation Areas at 1478 Valley Ford Freestone Road

The total proposed canopy is **43,511** square feet of cultivation area. Outdoor cultivation areas are marked A1, A2 and A3 and B1, B2, and B3 on the attached Full Property Site Plan.

Cultivation area A1 contains 15 rows of 21 plants. Every row will grow to a maximum of about 8' x 130' creating a cultivation area of 15,600 square feet.

Outdoor cultivation area A2 contains 14 rows with 46 plants. Every row will grow to a maximum of about 6' x 188' creating a cultivation area of 15,792 square feet.

Outdoor cultivation area A3 contains 15 rows with 23 plants. Every row will grow to a maximum of about 6' x 90' and 1 row of 17 plants that will grow to a maximum of about 6' x 66' creating a combined total cultivation area of 8,496.

B1 is a Hoop-House, non-permanent structure with dimensions of 10' x 75' creating 750 square feet of area for propagation. Plants in this area will not be allowed to reach maturity.

B2 is a hoop-house non-permanent structure with dimensions of 18' x 75' creating 1,350 square feet of cultivation area.

B3 is a hoop-house non-permanent structure with dimensions of 18' x 100' creating 1,800 square feet of cultivation area.

Proposed Processing Area

The processing and packaging area is marked as Exhibit C on the Full Property Site Plan and can be seen in more detail in the Processing Area Site Plan. This area is a covered carport area that is technically outdoors. No cannabis is stored here.

Proposed Indoor and Nursery Area

The Indoor Cultivation Area, Clone Propagation and Nursery Area is marked as D on the Site Plan and is an existing permitted structure. This area is 500 square feet and is used alternatively for Indoor Cultivation, clone propagation and a Nursery because these 3 tasks substantially overlap. From February to May this area is used for Clone Propagation and as a Nursery. During November and December this area is used for drying of processed cannabis. The rest of the year this area serves for Indoor Cultivation Activities.

Summary of Proposed Cultivation Areas at 1478 Valley Ford Freestone Road

Operations Model

All plants are propagated in room D between the months of February and May. Building D is an existing 500 square foot permitted structure. As plants begin to take root and are transferred from rock-wool to pots they are taken outside to Hoop House B1 a non-permanent seasonal structure. Hoop -house B1 exists to protect these young plants from wind damage and sudden changes in temperature and humidity.

As the first plants reach maturity and become well vegetated they are moved to Area A1. Area A1 will end up with the largest plants seasonally because these are the first clones to be permanently rooted outdoors. Clones will continue to be produced until the propagation conducted in Area D is enough to populate areas A1, A2, A3, B2 and B3.

Room D will additionally be used as a wholesale nursery for sale to other farms and dispensaries. The 500 square feet of space in Area D are capable of producing enough clones to populate the entire farm and still have a surplus for sale. No visitors would be permitted on site to purchase or view clones at any time. Areas A1, A2 and A3 are harvested once seasonally in late October or early November. Areas B2 and B3 would be mixed-light hoop-houses and would be harvested twice seasonally. Plants in Hoop-house B1 will never be brought to maturity. By the time all of the Cannabis flowers have been harvested there is no longer a need for clones. The clone propagation hardware in Room D is disassembled and replaced with Drying Racks, fans, air-conditioners and dehumidifiers in order to safely store and dry the cannabis. After a few weeks of drying the cannabis is ready for sale to a Licensed Distributor.

Construction

Construction

No new buildings are being proposed except for the ADA Compliant Public Restroom which is 10' x 12' for a total of 120 square feet. Its proposed location is on the site plan.

Parking

6 parking spots are planned for the parking area in the southwestern corner of the property.

1478 Valley Ford Freestone Road
 APN: 026-080-009
 Application #: UPC17-0069
 Property Owner: Albert Eaddy

There is no Proposed Grading for this project.
 There is no Proposed Well for this project.
 This Plan was Resubmitted on May, 28th 2020.

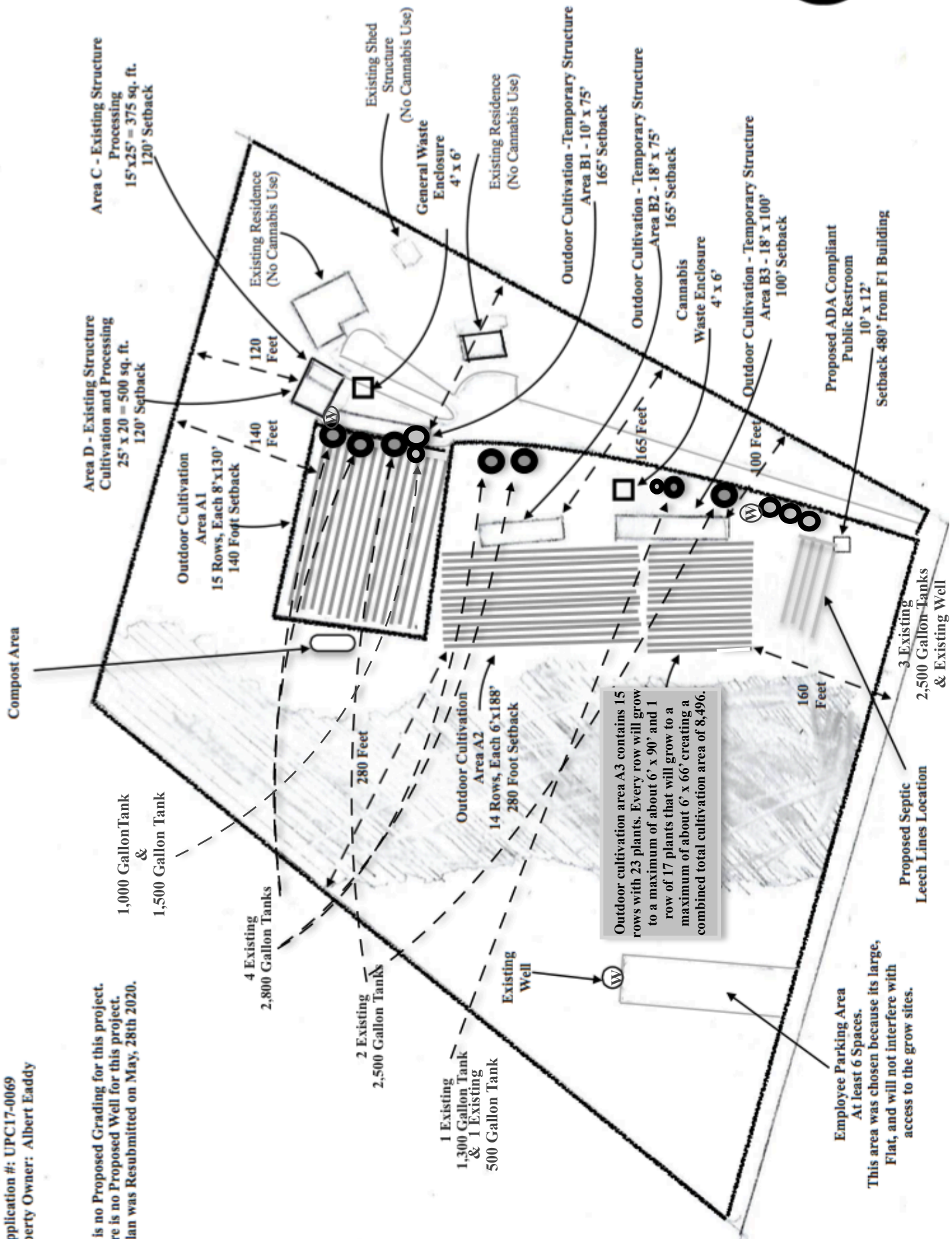

Processing Area Site Plan
 Free Stone Ranch, LLC
 APN: 026-080-009

Room D

Room C

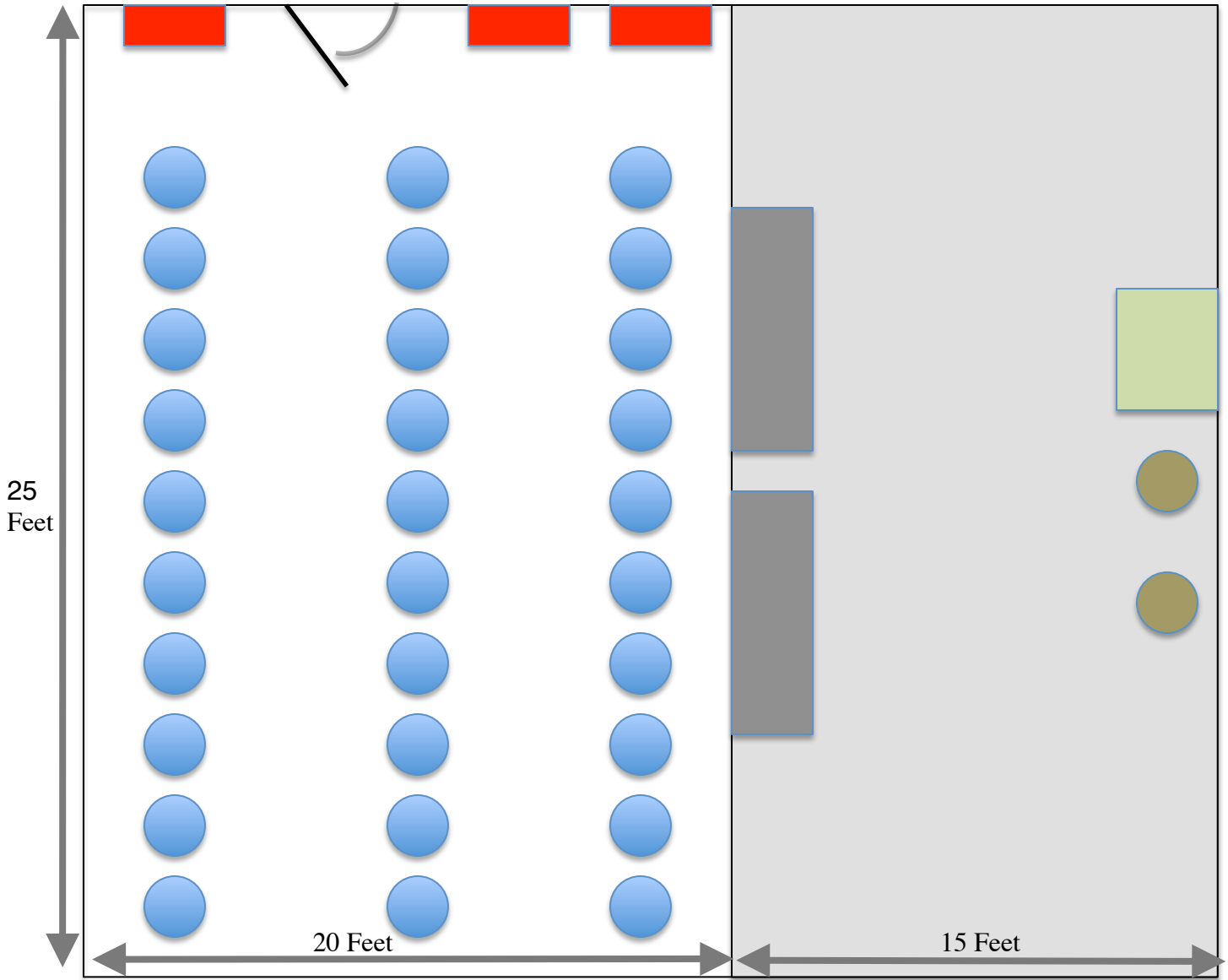

The 2 Grey Rectangles represent tables used to hold cannabis plants while they await deleafing and trimming procedures. Both tables are 2.5' wide x 6' long.



The 30 blue circles represent mesh drying racks that hang from the ceiling. They are between 2' and 3' diameter and are between 5' and 6' long but do not touch the ground.



The 2 Dark Green Circles represent a deleafing machine called the "Trim Reaper." They're round and have a 2' Diameter.



The 3 Red Rectangles represent chemical storage which are metal tool chests produced by the "Husky" brand. The Tool Chests are 3' long 3' tall and 2' deep/wide.

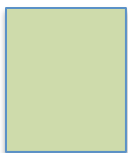

The light green square represents a trimming machine known as the "Trimminator" which is used for processing fresh cannabis plants.