

PLAN

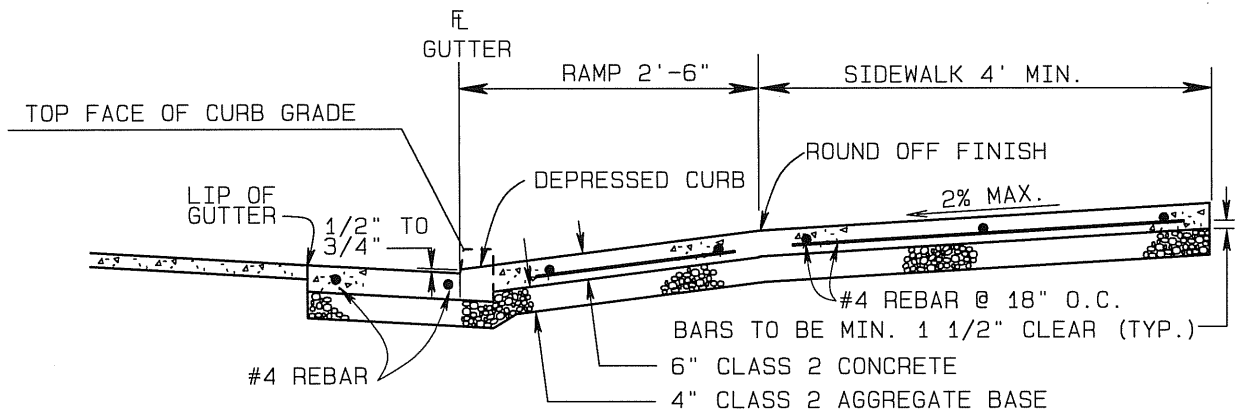

SECTION A-A

NOTES:

1. REBAR TO BE PLACED IN THAT PORTION OF DRIVEWAYS LOCATED WITHIN THE RIGHT OF WAY.
2. BASE MATERIAL SHALL BE COMPACTED TO A RELATIVE COMPACTION OF 95%.
3. CONSTRUCT A WEAKENED PLANE JOINT AT THE CENTER OF THE DRIVEWAY (1/8" WIDE BY 1" DEEP). CONSTRUCT SCORE MARKS AT A MAXIMUM SPACING OF 5 FEET.
4. AS AN ALTERNATE ON COMMERCIAL DRIVEWAYS, THE SIDEWALK GRADE THROUGH THE DRIVEWAY MAY BE DEPRESSED 2". THE SIDEWALK GRADE TRANSITIONS SHALL BE ACCOMPLISHED IN THE 4-FOOT OFFSET SECTION.
5. CONCRETE CONTAINING SIX SACKS OF CEMENT PER CUBIC YARD MEETS THE CRITERION FOR CLASS 2 CONCRETE.

**COUNTY OF SONOMA
DEPARTMENT OF TRANSPORTATION
AND PUBLIC WORKS**

**URBAN DRIVEWAY
LIGHT USE
COMMERCIAL AND
RESIDENTIAL**

DATE: MAY 2004

REVISED: FEB. 2009

APPROVED BY:

SCALE:
NONE

DRAWING NO.

808