

PLAN

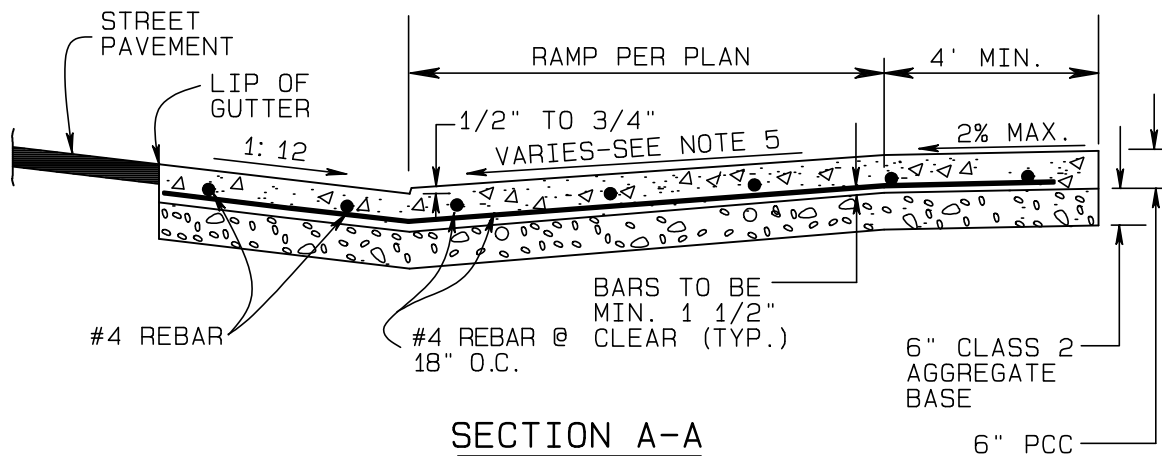

SECTION A-A

NOTES:

1. REBAR SHALL BE PLACED IN THAT PORTION OF DRIVEWAYS LOCATED WITHIN THE RIGHT OF WAY.
2. A PEDESTRIAN RAMP SHALL BE CONSTRUCTED AT ANY RETURN INTERSECTED BY A PUBLIC SIDEWALK. RAMP TYPES MAY VARY. SEE DRAWING NOS. 224A AND 224B.
3. CONCRETE SHALL CONTAIN SIX SACKS OF CEMENT PER CUBIC YARD.
4. AN EXPANSION JOINT SHALL BE INSTALLED AT THE TOP OF THE DRIVEWAY RETURN. SEE DRAWING NO. 222.
5. THE TOP OF RAMP ELEVATION SHALL BE EQUAL TO, OR GREATER THAN THE LIP OF GUTTER ELEVATION.

**COUNTY OF SONOMA  
DEPARTMENT OF TRANSPORTATION  
AND PUBLIC WORKS**

**URBAN DRIVEWAY  
HEAVY USE  
COMMERCIAL**

DATE: MAY 2004  
REVISED: NOV. 2009

SCALE:  
NONE

DRAWING NO.  
**806**