

Xrefs: S:\ENGINEERING\Traffic\STAFF FOLDERS\Draft Revised Standards\Revised_County Standards_Master.dwg Plot Date: Nov 12, 2020 at 08:10

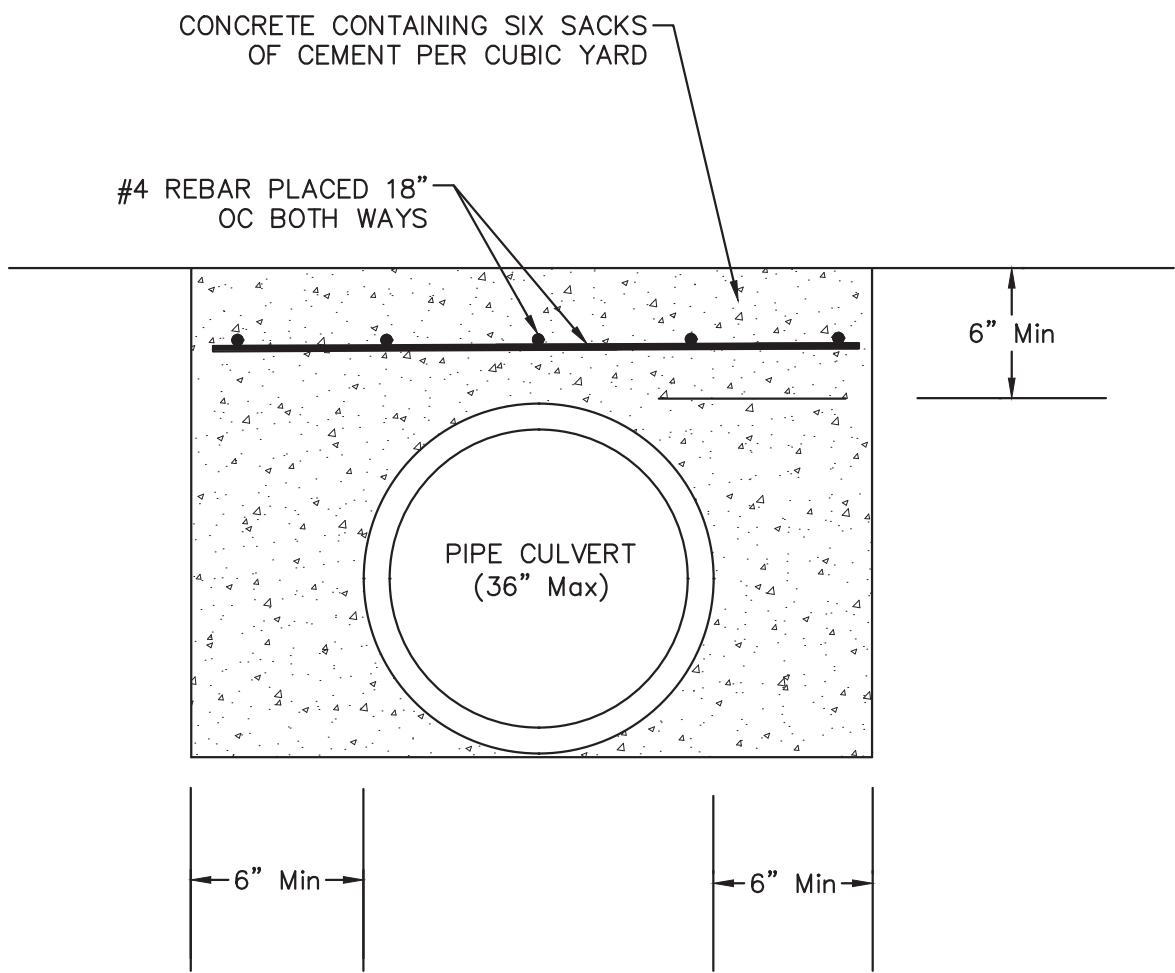

NOTES:

- 1. INSTALLATION PROCEDURES SHALL INCLUDE METHODS TO PREVENT FLOTATION OF PIPE.

COUNTY OF SONOMA DEPARTMENT OF TRANSPORTATION AND PUBLIC WORKS		
CONCRETE CAP (DRIVEWAY CULVERT)		
DATE: JAN. 2005	REVISED:	
APPROVED BY: JH	SCALE: NONE	DRAWING NO. 409